

BEFORE THE OFFICE OF STRATEGIC
AND LONG RANGE PLANNING
OF THE STATE OF MINNESOTA

IN THE MATTER OF THE ORDERLY ANNEXATION)
AGREEMENT BETWEEN THE CITY OF BUFFALO)
AND THE TOWN OF BUFFALO PURSUANT TO)
MINNESOTA STATUTES 414)

ORDER

WHEREAS, a joint resolution for orderly annexation was adopted by the City of Buffalo and the Town of Buffalo; and

WHEREAS, a resolution was received from the City and Town of Buffalo indicating their desire that certain property be annexed to the City of Buffalo pursuant to M.S. 414.0325, Subd. 1; and

WHEREAS, M.S. 414.0325 states that in certain circumstances the Minnesota Municipal Board may review and comment, but shall within 30 days order the annexation of land pursuant to said subdivision; and

WHEREAS, on August 6, 1999, the Director of the Office of Strategic and Long Range Planning has reviewed and accepted the resolution for orderly annexation;

IT IS HEREBY ORDERED: That the following described property is hereby annexed to the City of Buffalo, Minnesota, the same as if it had originally been made a part thereof.

The Southwest Quarter of the Northeast Quarter and that part of the North 16.16 acres of Government Lot 2 lying east of the centerline of County Highway Number 14 all in Section 16, Township 120, Range 25, Wright County, Minnesota except the following two tracts of land:

- 1.) A tract of land in Government Lot 2 in Section 16, Township 120, Range 25, Wright County,

9902972

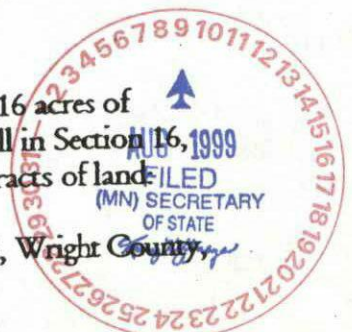

Minnesota described as follows: Begin at a point in the middle of the Buffalo-Pelican Lake Road and on the south line of Government Lot 2 in said Section 16; thence North 87 degrees East, a distance of 632.2 feet more or less, to the east line of said Government Lot 2; thence North on said line, a distance of 457 feet to an old established fence line; thence West following said fence line and said line extended to the middle of the said Buffalo-Pelican Lake Road, a distance of 459 feet; thence Southwesterly along the middle of said Buffalo-Pelican Lake Road, a distance of 500.8 feet to the point of beginning.

2.) That part of Government Lot 2, Section 16, Township 120, Range 25, Wright County, Minnesota described as follows: Beginning at an iron monument marking the point of intersection of the north line of said Government Lot 2 and the center line of County Road Number 114; thence east along the north line of Government Lot 2, 208.7 feet; thence south at right angles (90 degrees), a distance of 208.7 feet; thence west parallel with the north line of said Government Lot 2, a distance of 299.08 feet to the center line of County Road Number 114; thence northeasterly along the center line of said road to the point of beginning.

That part of the Southeast Quarter of the Northeast Quarter of Section 16, Township 120, Range 25, Wright County, Minnesota, described as follows: Beginning at the northwest corner of said Southeast Quarter of the Northeast Quarter of Section 16; thence South 89 degrees 42 minutes 09 seconds East, assumed bearing, along the north line of the said Southeast Quarter of the Northeast Quarter, a distance of 95.30 feet; thence South 12 degrees 51 minutes 09 seconds West, a distance of 290.00 feet; thence South 64 degrees 23 minutes 06 seconds East, a distance of 348.50 feet; thence South 13 degrees 14 minutes 51 seconds West, a distance of 487.32 feet; thence South 4 degrees 12 minutes 50 seconds West, a distance of 412.07 feet to the south line of said Southeast Quarter of the Northeast Quarter; thence North 89 degrees 51 minutes 01 second West along said south line, a distance of 200.00 feet to the southwest corner of said Southeast Quarter of the Northeast Quarter; thence North 0 degrees 08 minutes 03 seconds West along the west line of said Southeast Quarter of the Northeast Quarter, a distance of 1318.68 feet to the point of beginning.

IT IS FURTHER ORDERED: That the effective date of this order is August 6, 1999.

Dated this 6th day of August, 1999.

Office of Strategic & Long Range Planning
Suite 225 Bandana Square
1021 Bandana Boulevard East
St. Paul, MN 55108

Christine M. Scotillo

Christine M. Scotillo
Executive Director
Municipal Board Office

